

**STANADYNE**  
Diesel Systems**SERVICE BULLETIN**LIMITED  
DISTRIBUTION

DATE: July 11, 1994

**LIMITED DISTRIBUTION - NAVISTAR INTERNATIONAL****SUBJECT: MECHANICAL SHUTOFF KIT FOR NAVISTAR  
6.9 AND 7.3L SCHOOL BUS APPLICATIONS**

A Mechanical Shutoff Kit, Part No. 26046, has been developed for Navistar 6.9 and 7.3 liter 1700 "S" series diesel school bus applications. In certain states there is legislation that requires that diesel powered school buses have a positive, mechanical means of engine shutdown.

This mechanical shutoff device replaces the standard electrical shutoff solenoid and enables the operator to shut down the engine through the use of a dashboard mounted control knob and cable attached directly to a control lever on the fuel injection pump governor cover. (Figure 1)

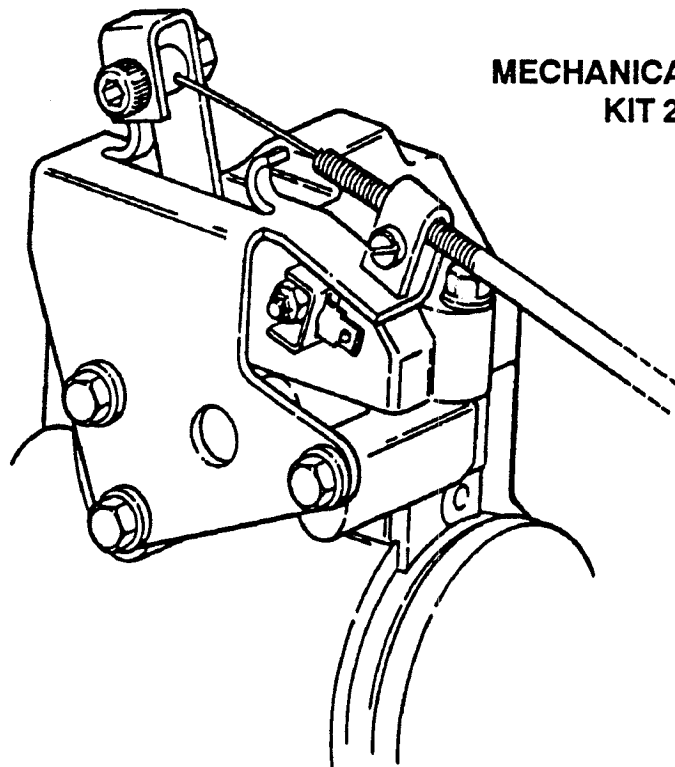
**MECHANICAL SHUTOFF  
KIT 26046****Figure 1**

This Mechanical Shutoff Kit, Part No. 26046, consists of the following items:

- Governor cover assembly with Housing Pressure Cold Advance (HPCA) solenoid, governor cover gasket, and return line connector seal.
- Cable mounting bracket and fasteners (cable not included).
- Installation Instruction sheet No. 99241.

An exploded view of the assembly is shown below (Figure 2) with all serviceable components identified for repair purposes. Should any non-serviceable components be required such as the governor cover assembly, then a complete kit must be ordered.

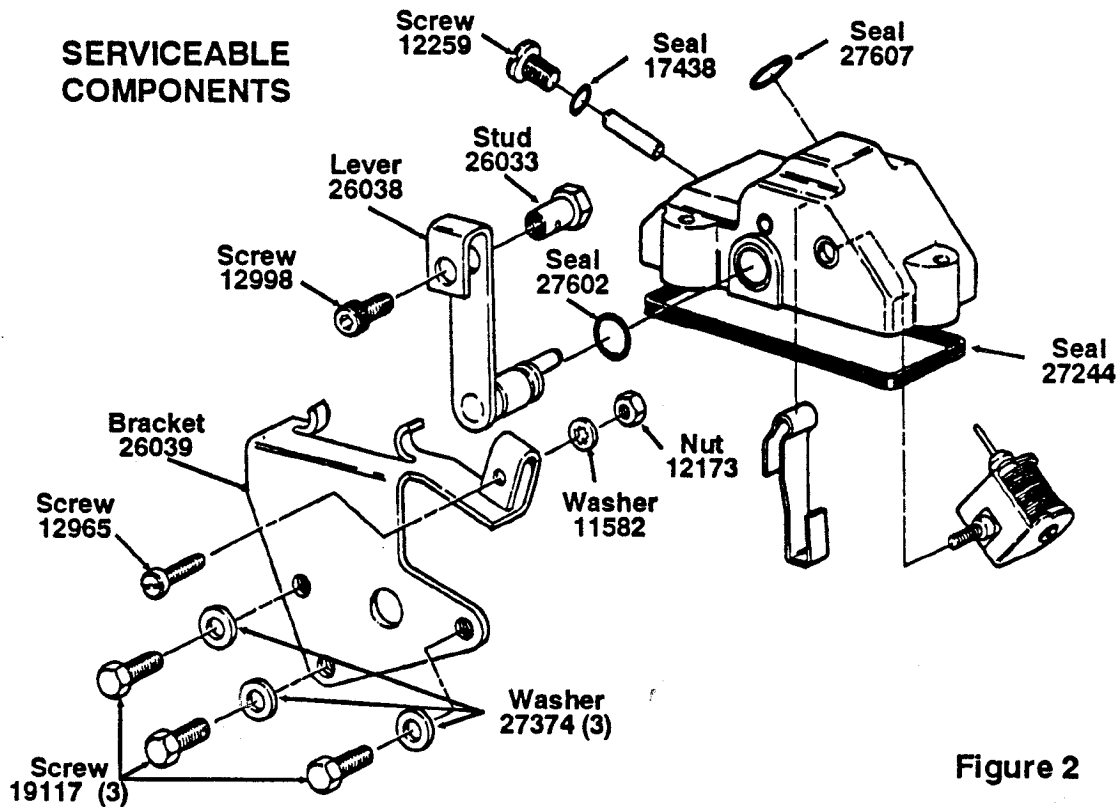

Figure 2

Technical Support Group  
Product Support Department